

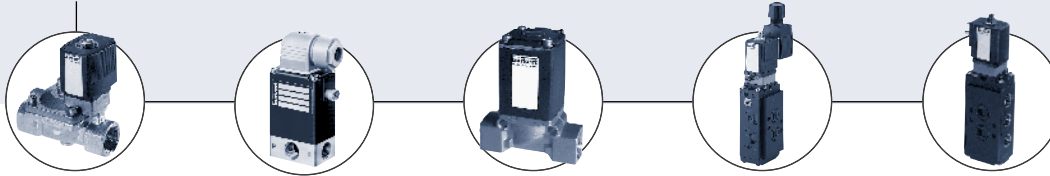

Same as Type 1078-1, except:

- Programmable using separate operating unit
- 8 different switching functions
- Program changes only possible with operating unit (protective function)
- 2-button operation with display

Type 1078-2 can be combined with...



**Type 5281/6213**

Solenoid valve

**Type 0330/0331**

Solenoid valve

**Type 0255/0256**

Solenoid valve

**Type 6518/6519**

Solenoid valve

**Type 6519 NAMUR**

NAMUR valve

The Type 1078-2 works on the basis of a micro-processor and is used for controlling the cycle times of solenoid valves. 8 different cycle times can be set up.

The controller is plugged onto the tag connector of the solenoid valve using the integrated instrument socket according to DIN 43650 Form A and can also be connected to a binary signal generator (Start and Reset).

The 1077-2 operating unit is used to set switching cycles and interval periods using the 2 function buttons. Once these parameters have been set, the operating unit can be removed from the timer unit. The programmed values remain stored in the operating unit and the controller.

#### Technical data

<b>Operating voltage</b>	12 - 24/24 - 48 V/DC, 24-48 V/50 - 60 Hz, 110 - 230V/50 - 60 Hz
<b>Voltage tolerance</b>	±10%
<b>Nominal power</b>	1.5 W
<b>Switching output</b>	For the control of solenoid valves etc.
<b>Switching voltage</b>	As operating voltage
<b>Switching current</b> at 12 - 24 V/DC at 24 - 48 V/50-60 Hz at 110 - 230 V/50-60 Hz	Max. 2 A Max. 1.5 A (7,5 A) Max. 0.5 A (2 A)
<b>Electrical connection</b>	5-pin terminal strip in the body, PG9 cable connector, up to 1.5 mm <sup>2</sup> wires, Cable Ø 6 to 7 mm, can be turned through 90°
<b>Number of terminals</b>	2 pins and protective conductor
<b>Plug connection</b>	Integrated cable plug to DIN 43650 Form A
<b>Protection class</b>	IP 65 with valve
<b>Clearance/leakage paths</b>	According to VDE 0100
<b>Operating temperature</b>	14°F to 140°F (-10°C to +60°C)
<b>Storage temperature</b>	14°F to 176°F (-10°C to +80°C)

<b>Operation</b>	With plug-on operating unit Type 1077-2
<b>Setting</b>	8 functions with 2 buttons on the operating unit Type 1077-2 (not supplied as standard) 0.2 s up to 9999 h, continuous
<b>Tolerance</b>	1%
<b>Resolution</b> Range up to 199 s Range up to 199 min Range up to 99 h Range up to 9999 h	10 ms 1 s 1 min 1 h
<b>Options</b>	Binary inputs for external triggering
<b>LED display</b>	Mains voltage Switch status
<b>Display</b> (on operating unit Type 1077-2)	4 1/2 digit 7-segment LCD display
<b>Installation</b>	As required
<b>Mounting</b>	With cheesehead screws
<b>Body material</b>	Polyamide

**Dimensions [mm]**

A Dimensions for timer unit with operating unit  
(not supplied as standard, please see ordering chart)  
B Dimension for timer unit without operating unit,  
with protection cover (supplied as standard)

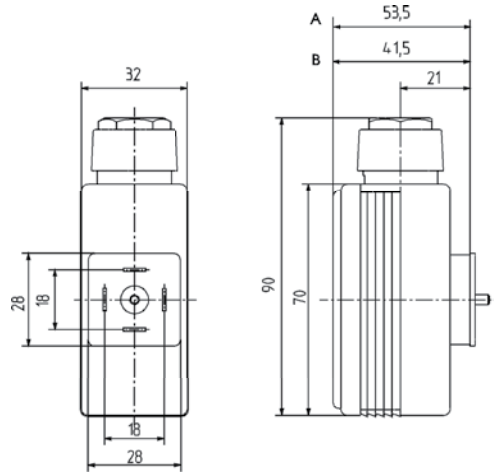

DTS 1000082405 EN Version: - Status: RL (released | freigegeben | valide) printed: 13.08.2008

**Functions/switching cycles of the timer unit**

$t_o$  = Start time  
 $t_{on}$  and  $t_{off}$  are freely selectable

**Functions**

- 1 Cycler, starting with "On", start with  $t_{on}$
- 2 Cycler, inverted, starting with  $t_{off}$
- 3 Pulse timer for the set time  $t_{on}$
- 4 Switch-on delay, only switches after duration of  $t_{off}$
- 5 Cycler with adjustable switch-on pulse
- 6 Cycler, time-delayed, starting with  $t_{off}$
- 7 Pulse generator, time-delayed, starting with  $t_{off}$
- 8 Pulse generator, inverted and time-delayed, starting with  $t_{on}$

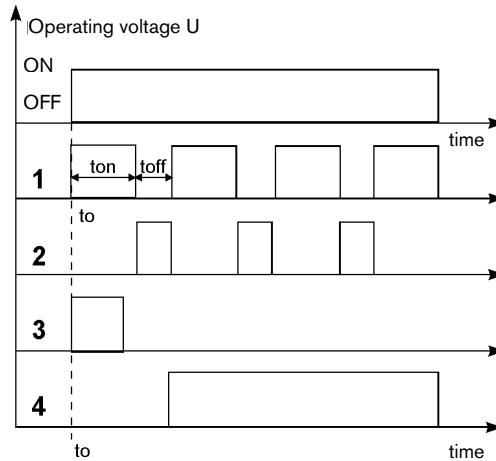

**Ordering chart for Type 1078-2**

Accessory	Operating voltage	Item no.
Timer unit Type 1078-2	12 - 24 V/DC0	060 648
	24 - 48 V/50-60 Hz and DC	060 629
	110 - 230 V/50-60 Hz	060 630
Programming unit Type 1077-2*		060 638

\* At least one programming unit is required in order to program the 1078-2 timer unit.  
Programming units can be removed from the timer and stored for safe keeping.