

Chip Vac™

Vacuums chips directly into a 55 gallon drum - with no moving parts.

What Is The Chip Vac?

EXAIR's Chip Vac picks up dry or wet chips and delivers them directly to an ordinary 55 gallon (40 imperial gallon) drum. Chip Vac is used to clean chips from fixtures, floors and work surfaces of machining centers, lathes, saws, mills and other industrial equipment. Now, with a 30% increase in vacuum, it is our most powerful Chip Vac ever!

Why The Chip Vac?

The compressed air operated Chip Vac is an industrial duty vacuum designed specifically for vacuuming chips. It creates a cyclonic action that vacuums metal, wood or plastic chips into a 55 gallon drum. Dusty materials such as absorbents are trapped by the 0.1 micron filter bag to keep the surrounding air clean.

Electrically operated "all purpose" vacuums aren't designed for use in industrial environments. As a result, motors wear out quickly and impellers clog. Chip Vac has no moving parts to wear out or break which ensures long life. Sound level is half that of electric vacuums.

Chip Vac's lever lock drum lid fits an ordinary open top 55 gallon drum. In less than a minute, the Chip Vac can be removed and easily placed onto another drum to keep different materials separate for recycling. Constant heavy lifting and dumping of vacuum cleaner tanks is eliminated since all chips are vacuumed directly to the 55 gallon drum.

Now 30% More Vacuum!

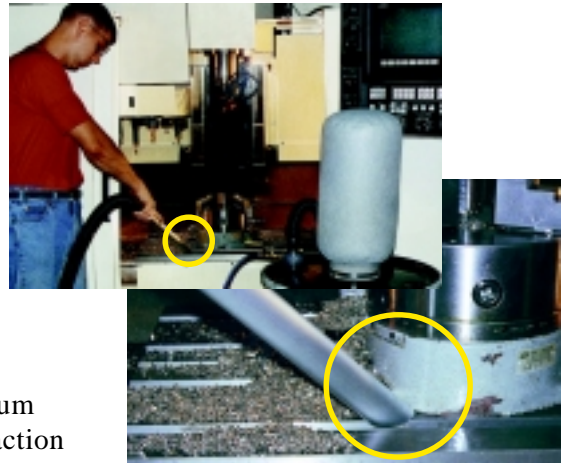

The Chip Vac removes abrasive stainless steel chips from a CNC.



Room air remains dust free as the Chip Vac removes dusty absorbent.



Chips can be vacuumed directly to separate drums for recycling.

Applications

- CNC's
- Lathes
- Saws
- Mills
- Drills
- Grinders
- Routers
- Molding machines
- Absorbent pick-up

Advantages

- No moving parts
- Low cost
- No motors to clog or wear out
- No electricity
- Dust free operation
- Chips go directly into a drum
- Powerful cyclonic action
- Includes accessories
- 50% quieter than electric vacs

Chip Vac

How The Chip Vac Works

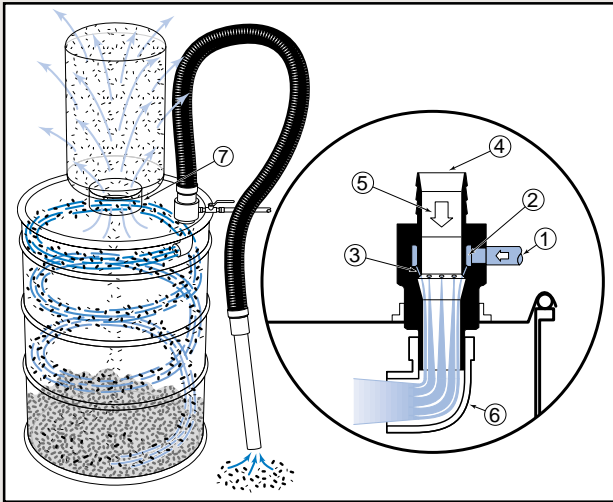

Compressed air, normally 80-100 PSIG (5.5 - 6.9 BAR), flows through the inlet (1) into an annular plenum chamber (2). It is then injected into the throat through directed nozzles (3). These jets of air create a vacuum at the intake (4) which draws material in and accelerates it through the unit (5). An elbow at the exhaust (6) directs the air in a cyclonic motion against the inside wall of the drum. Chips and other particulate drop to the bottom of the drum. The airflow exhausts through the port in the drum lid (7). Airborne particulates are trapped by the 0.1 micron filter bag.

The Chip Vac System can be used with an open head steel, fiber or plastic drum that is in good condition (ANSI Standard #MH2-1997). To prevent material contamination, a poly drum liner can be inserted into the drum.

Chip Vac Specifications

Pressure Supply		Air Consumption		
PSIG	BAR	SCFM	SLPM	INLET
80	5.5	40	1132	3/8 NPT

Air consumption has been minimized by using the appropriate amount of air required for vacuuming chips.



The Model 6193 Chip Vac System includes a vacuum hose, chip wand and tools.



The Model 6293 Chip Vac System includes all items shown above and a Model 9041 drum dolly.

Chip Vac Systems

Model #	Description
6193	Chip Vac System includes the Chip Vac, lever lock drum lid, shutoff valve, filter bag, 10' (3m) chemical resistant hose (1-1/2"/38mm I.D.), chip wand, extensions, crevice tool, brush, skimmer and floor tool (drum not included).
6293	Chip Vac System - same as above and adds drum dolly (drum not included).

Accessories

Model #	Description
6804	Replacement Filter Bag, 0.1 micron, 95% efficient
9001	Auto Drain Filter Separator, 3/8 NPT, 65 SCFM (1841 SLPM)
9005	Oil Removal Filter, 3/8 NPT, 15 - 37 SCFM (425 - 1048 SLPM)
9041	Drum Dolly



See page 2 for complete details.

Drum Vac™

**Pump 55 gallons
in 90 seconds!**

**Two models for
one or two-way
pumping action.**

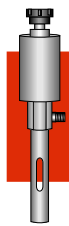

**All Stainless Steel Pump!
No Brass or Aluminum!**

What Is The Drum Vac?

A safe, maintenance free way to recover:

- Coolant
- Hydraulic oils
- Liquid spills
- Sludge and chips
- Tramp oil
- Waste water

One Or Two-Way Pumping

EXAIR's compressed air operated **Model 6195 Drum Vac System** attaches quickly to any closed head 55 gallon (40 imperial gallon) drum. Its high powered vacuum **fills** the drum in less than two minutes. No moving parts or electricity assures maintenance free operation. An automatic safety shutoff valve prevents spills or overfilling.

With the turn of a knob, EXAIR's **Model 6196 Reversible Drum Vac System** will quickly **fill or empty** a 55 gallon (40 imperial gallon) drum. Coolant sumps can be easily refilled, or contaminated liquids transferred to filtration tanks in minutes. The flow rate in and out of the drum can be controlled with the knob, making it ideal for dispensing liquids.

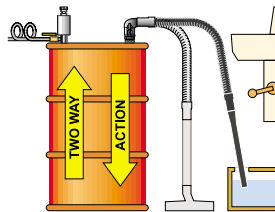

Model 6901 Spill Recovery Kit used with the Drum Vac provides fast cleanup of messy spills.



Model 6296 Reversible Drum Vac fills or empties machine sumps quickly and easily.

Applications

- Coolant sumps
- Food processing
- Lathes
- Floor cleanup
- EDM machines
- Pits
- Screw machines
- Machining centers
- Tanks

Advantages

- No moving parts
- Maintenance free
- Stainless steel construction
- Safe – no electricity
- Built-in pressure/vacuum relief
- Compact and portable
- Installs quickly
- Spill free – auto safety shutoff
- Fits standard closed head drum

Drum Vac

Drum Vac Specifications

MODEL	DESCRIPTION	Air Consumption		Water Flow Rate	
		SCFM	SLPM	GPM	LPM
6195	DRUM VAC	19	538	40	151
6196	REVERSIBLE DRUM VAC	19	538	30	114

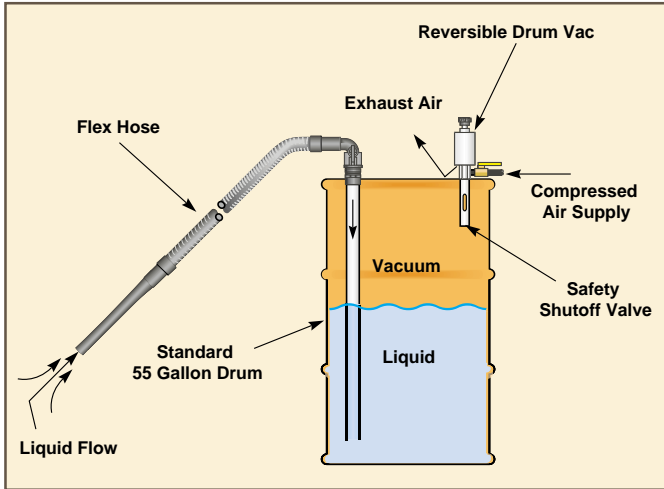

Warning: Do not use with any material with a low flash point or with flammable liquids such as fuel oil, alcohol, mineral spirits, gasoline, or kerosene.



The Model 6195 Drum Vac and Model 6196 Reversible Drum Vac Systems includes a vacuum hose and aluminum wand.



The Model 6295 Drum Vac and Model 6296 Reversible Drum Vac Systems includes a drum dolly, spill recovery kit, vacuum hose and all tools.

Drum Vac Systems

Model #	Description
6195	Drum Vac System - includes one-way pump assembly (1/4 NPT), shutoff valve, 10' (3m) flexible vacuum hose (1-1/2"/38mm I.D.) with 90° quick release elbow connection, (1) aluminum wand (drum not included).
6295	Deluxe Drum Vac System - same as above and adds drum dolly, spill recovery kit, (2) extension wands, crevice tool, and skimmer tool (drum not included).
6196	Reversible Drum Vac System - includes two-way pump assembly (1/4 NPT), shutoff valve, 10' (3m) flexible vacuum hose (1-1/2"/38mm I.D.) with 90° quick release elbow connection, (1) aluminum wand (drum not included).
6296	Deluxe Reversible Drum Vac System - same as above and adds drum dolly, spill recovery kit, (2) extension wands, crevice tool, and skimmer tool (drum not included).

Accessories

Model #	Description
9001	Auto Drain Filter Separator, 3/8 NPT, 65 SCFM (1841 SLPM)
9005	Oil Removal Filter, 3/8 NPT, 15 - 37 SCFM (425 - 1048 SLPM)
9041	Drum Dolly
6901	Spill Recovery Kit includes a one-piece 54" (1.4m) ABS wand and 14" (36cm) double blade squeegee tool.





Vac-u-Gun™

Vacuum, blow and transfer with no moving parts!

What Is The Vac-u-Gun?

A low cost solution to a wide variety of industrial housekeeping problems. The Vac-u-Gun is a vacuum gun, a blow gun and a transfer tool all-in-one. Lightweight and easy to use, the Vac-u-Gun has durable die cast construction with no moving parts to wear out.

The Vac-u-Gun uses less compressed air than an ordinary blow gun. It injects a small amount of compressed air through directed nozzles to produce a vacuum on one end and a high output flow on the other. The amplified output flow is 12 times the air consumption rate.

Applications

Vacuum:

- Shavings
- Absorbent
- Sawdust

Transfer:

- Spills
- Small parts
- Pellets
- Trim

Blow:

- Chips
- Water
- Coolant
- Scrap

Advantages

- Low cost
- No moving parts – maintenance free
- Durable – die cast construction
- Safe – no electricity
- Meets OSHA pressure requirements
- Vacuum or blow off
- Lightweight and portable
- Versatile
- Quiet



Model 6192 Vac-u-Gun Collection System with bag, vacuums absorbent and chips.



Model 6292 Vac-u-Gun Transfer System carries dust away from sensitive electronic controls.



Model 6392 Vac-u-Gun All Purpose System removes plastic shavings from a saw.

Vac-u-Gun

Vac-u-Gun Specifications

Pressure Supply		Air Consumption		INLET
PSIG	BAR	SCFM	SLPM	
80	5.5	13	368	1/4 NPT

Versatile

In seconds, the Vac-u-Gun can be transformed from a powerful vacuum gun into an efficient blow gun or into a transfer tool for lightweight materials. Each Vac-u-Gun System comes complete with a set of attachments to suit numerous industrial applications.

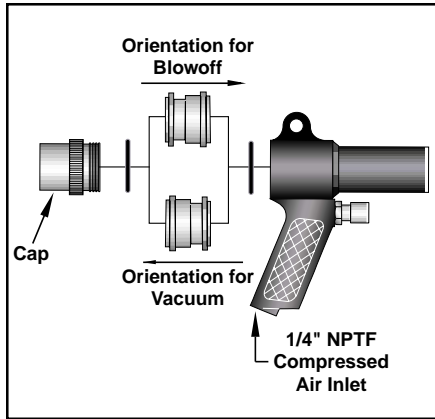

Reverse the direction of the nozzle insert to change from vacuum to blowoff.



In blow mode, the Vac-u-Gun consumes less air than ordinary blow guns.

Vac-u-Gun Systems



Model 6192 Collection System includes Vac-u-Gun, re-usable bag, brush, crevice tool, skimmer tool and (2) extension wands.



Model 6292 Transfer System includes Vac-u-Gun, 10' vacuum hose, brush, crevice tool, skimmer tool and (2) extension wands.



Model 6392 All Purpose System includes Vac-u-Gun, re-usable bag, 10' vacuum hose, brush, crevice tool, skimmer tool and (2) extension wands.

Accessories

Model #	Description
9001	Auto Drain Filter Separator, 3/8 NPT, 65 SCFM (1841 SLPM)
9005	Oil Removal Filter, 3/8 NPT, 15 - 37 SCFM (425 - 1048 SLPM)

Deep Hole Vac-u-Gun™

Blow chips loose and vacuum them away in one step!

Ideal for cleaning cavities and drilled holes!



What Is The Deep Hole Vac-u-Gun?

A low cost solution to quickly remove chips and contaminants from grooves, containers and drilled holes. The Deep Hole Vac-u-Gun replaces dangerous blow guns that can cause chips or debris to fly in all directions. Simply position the Deep Hole Vac-u-Gun over the hole and press the trigger. A small blow tube dislodges and lifts the chips while the large suction tube vacuums them away. The operator is protected from flying debris since all contaminants are contained within the clear suction tube. It is perfect for cleaning holes up to 1-1/4" (32mm) diameter at a depth of 18" (46cm).

The Deep Hole Vac-u-Gun uses less compressed air than an ordinary blow gun. It injects a small amount of compressed air through directed nozzles to produce a vacuum on one end and a high output flow on the other. The amplified output flow is 12 times the air consumption rate.

Lightweight and easy to use, the Deep Hole Vac-u-Gun has a durable die cast construction with no moving parts to wear out. A hanger is provided for easy storage or for mounting on a tool balancer.

Applications

- Holes in fixtures
- Drilled plastics
- T-slots – groove cleaning
- Coolant evacuation from parts
- Woodworking
- Container cleaning
- Tapped holes
- Cupped surfaces
- Cavity evacuation
- Bottle cleaning
- Punch press tables

Advantages

- Low cost
- No moving parts – maintenance free
- Durable – die cast construction
- Eliminates shock hazard - no electricity
- Meets OSHA pressure and chip guard requirements
- Safe operation - no flying chips
- Lightweight and portable
- Quiet
- Low air consumption



Model 6394 Deep Hole Vac-u-Gun All Purpose System removes the chips from a drilled plastic part.

Deep Hole Vac-u-Gun

How The Deep Hole Vac-u-Gun Works

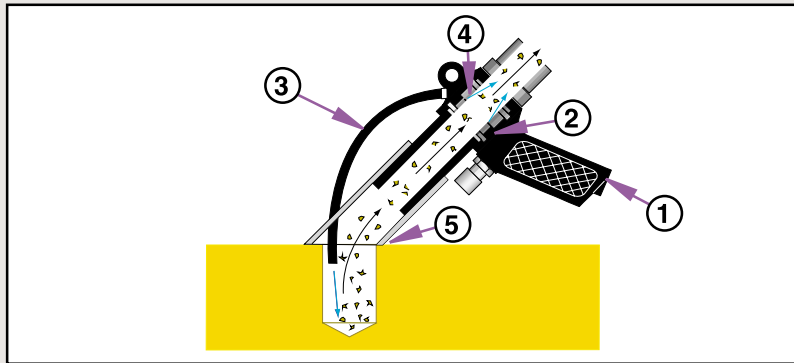

Compressed air, normally 80-100 PSIG (5.5 - 6.9 BAR), flows through the inlet (1) into an annular plenum chamber (2) when the trigger is depressed. A small amount of air is

injected into the blow tube (3) to provide lift for the chips or debris. The larger airflow is injected into the throat of the gun through directed nozzles (4). These jets of air create

a vacuum at the intake (5) which draws material in and accelerates it through the unit. The chips or other particulate can be exhausted into a filter bag or hose.

Deep Hole Vac-u-Gun Specifications

Pressure Supply		Air Consumption		Vacuum		
PSIG	BAR	SCFM	SLPM	"H ₂ O	kPa	INLET
80	5.5	15	425	32	8	1/4 NPT

The Deep Hole Vac-u-Gun should not be operated without a filter bag or vacuum hose attached to the exhaust. Vacuum tools can not be used with this product.

Deep Hole Vac-u-Gun Systems



Model 6094
Deep Hole Vac-u-Gun Only



Model 6194
Deep Hole Vac-u-Gun with Bag
includes Deep Hole Vac-u-Gun and re-usable bag.



Model 6394
Deep Hole Vac-u-Gun
All Purpose System
includes Deep Hole Vac-u-Gun, re-usable bag and 10' vacuum hose.

Accessories

Model #	Description
9001	Auto Drain Filter Separator, 3/8 NPT, 65 SCFM (1841 SLPM)
9005	Oil Removal Filter, 3/8 NPT, 15 - 37 SCFM (425 - 1048 SLPM)



Air Disk™ Window Blowoff

Keep the window of your CNC lathe clear of coolants!

View the part and the process at all times!



When the Air Disk Window Blowoff is off, the view is completely blocked.

What Is The Air Disk Window Blowoff?

EXAIR's new Air Disk Window Blowoff gives the machine operator a clear view of the part and the machining operation when coolants or cutting fluids are used.

Why The Air Disk Window Blowoff?

To keep up with the constantly increasing feeds and speeds of today's machine tools, high volumes of flood coolant must be used. As a result, a heavy coolant spray is often thrown against the window that eliminates visibility of the part and the machining process.

Using EXAIR's patented airflow technology, the Air Disk Window Blowoff provides a 360° airstream that blows outward from the center of the window. The unobstructed view to the inside of the machine:

- Permits faster machine set up and part tests
- Helps to avoid costly mistakes
- Eliminates downtime and damage to the tools and the machine
- Increases productivity
- Makes it easy to monitor the tools condition to determine if replacement is necessary



When compressed air is turned on, the Model 6200 Air Disk Window Blowoff keeps the part and process visible.



Advantages

- Low cost
- Faster set up
- Avoid costly mistakes
- Eliminate tool and machine damage
- Increase productivity
- Eliminate downtime
- Monitor tool life - eliminate part rejects
- No mechanical wiper to scratch the window
- No electricity
- No moving parts to wear out
- Quiet
- Includes push fittings and valve
- Easy installation
- Lightweight, low profile
- Adhesive bond - no holes in the window
- Amplifies airflow to minimize compressed air use

*Patent #5402938

Air Disk Window Blowoff

Air Disk Specifications

Pressure Supply		Air Consumption		INLET
PSIG	BAR	SCFM	SLPM	
80	5.5	17	481	1/8 NPT

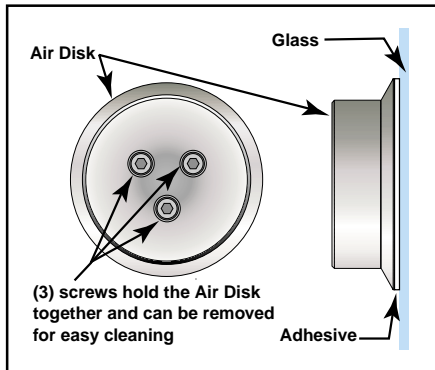

Strong peel and stick adhesive bonds the unit to the glass.

Warning: Compressed air must be turned off before opening the door of the CNC to prevent airborne coolant from contacting the machine operator.

Air Disk Dimensions

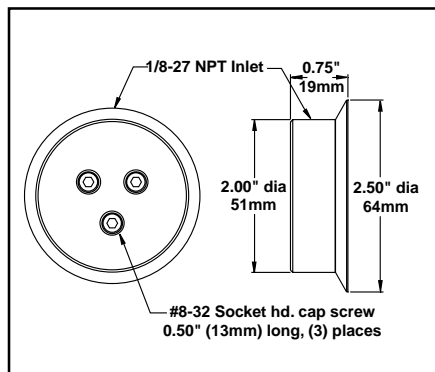

Air Disk Systems

Air Disk Window Blowoff Only	
Model #	Description
6100	Air Disk Window Blowoff
Air Disk Window Blowoff Kit	
Model #	Description
6200	includes Air Disk Window Blowoff, tubing, fittings, shutoff valve and filter separator.

Air Disk Window Blowoff System

The Air Disk Window Blowoff comes with all the necessary connections for fast, easy set up. The compact design permits mounting in machines that are fitted with bars or grills that protect the window. A strong adhesive bonds the Air Disk Window Blowoff to the glass or polycarbonate window of the CNC lathe. A shutoff valve gives the operator control of the air velocity so it can be increased when there is a high volume of coolant on the window. An optional solenoid valve can be wired into the machine control to limit the operation to only those times when coolant is being used, or actuated by using a special code in the program.



Model 6200 Air Disk Window Blowoff Kit includes the Air Disk Window Blowoff, tubing, fittings, shutoff valve, adhesive disks, alcohol swabs for window cleaning, shim set and filter separator.

Accessories	
Model #	Description
9001	Auto Drain Filter Separator, 3/8 NPT, 65 SCFM (1841 SLPM)
9005	Oil Removal Filter, 3/8 NPT, 15-37 SCFM (425-1048 SLPM)
9008	Pressure Regulator with Gauge, 1/4 NPT, 50 SCFM (1416 SLPM)
9020	Solenoid Valve Only (120V, 50/60 Hz), 1/4 NPT, 40 SCFM (1133 SLPM)



See page 2 for complete details.