

Super Air Wipe™

Blowoff, dry, clean
and cool pipe, cable,
extruded shapes,
hose, and wire!

Split design requires
no threading!

- ✓ Uniform 360° Airflow!
- ✓ For Environments Up To 800°F
- ✓ Variable Force And Flow!

What Is The Super Air Wipe?

EXAIR's Super Air Wipe provides a uniform 360° airstream that is ideal for blowoff, drying, cleaning and cooling of pipe, cable, extruded shapes, hose, wire and more. The split design offers easy clamping around the surface of the material moving through it, eliminating the need for threading. All models include stainless steel screws and shims. Stainless steel wire braided hose is also included on sizes up to 4" (102mm) for added corrosion and heat resistance. Aluminum models are rated for temperatures up to 400°F (204°C) and stainless steel models for temperatures up to 800°F (427°C).



The Super Air Wipe uniformly dries a hose as it exits a bath.



The split design of the Super Air Wipe unlatches easily to eliminate threading.

Applications

- Drying after wash, cleaning, plating or coating
- Blowoff dust and contaminants
- Cool hot extruded shapes
- Uniformly wipe surfaces
- Dry extruded profiles, rod and medical tubing
- Eliminate solution carryover - no cross contamination
- Blow excess water from automotive door gaskets
- Remove excess coatings, water and oil
- Dry tube, hose, wire, fiber optics
- Minimize solution loss due to drag-out
- Clean paint gun tips
- Dry screen printed or ink jetted surfaces
- Clean strips and ribbon

Advantages

- Quiet
- Low air consumption
- Uniform airflow across the entire diameter
- Stainless steel hardware resists corrosion
- Aluminum models for temperatures up to 400°F (204°C)
Stainless steel models for temperatures up to 800°F (427°C)
- Stainless steel hose supplied on sizes up to 4" (102mm)
- No electricity, no moving parts
- Non-contact - no wiper blade
- Split design - compact, rugged, easy to install
- Lightweight, low profile
- Tapped holes for mounting
- Variable force and flow
- Meets OSHA maximum dead end pressure and noise requirements

Super Air Wipe

How The Air Wipe Works

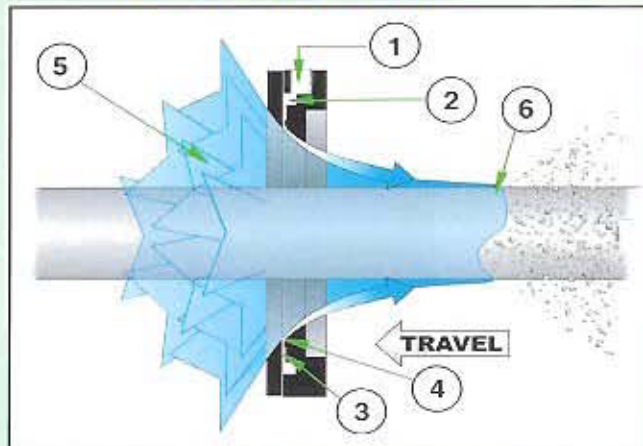

Compressed air flows through an inlet (1) of the Air Wipe into an annular chamber (2). It is then throttled through a small ring nozzle (3) at high velocity. This primary airstream adheres to the coanda profile (4), which directs it down the angled surface of the Air Wipe. A low pressure area is created

at the center (5) inducing a high volume flow of surrounding air into the primary airstream. As the airflow leaves the Air Wipe, it creates a conical 360° ring of air that attaches itself to the surface of the material running through it (6), uniformly wiping the entire surface with the high velocity airflow.

Why The Super Air Wipe?

Prior to the introduction of the Super Air Wipe, the only way to blowoff, dry, clean and cool round or extruded surfaces was to use a ring of air nozzles. The high air consumption and noise levels of the nozzles along with inconsistent air velocity often delivered poor results. The Super Air Wipe provides a high volume, high velocity airflow that is uniformly ejected from the 360° of its inner diameter. The airstream attaches itself to the material running through it. Velocity can be varied from a "blast" to a "breeze". Air consumption and noise are low.



The Aluminum Super Air Wipe is available in many sizes from stock. The Stainless Steel Super Air Wipe is available in 4 sizes from stock. Other sizes are available by special order.



The Model 2402 2" (51mm) Super Air Wipe cools PVC pipe as it is ejected from an extruder.

Super Air Wipe Is Easy To Use

There is a 1/4 NPT female inlet on each half of the Super Air Wipe on sizes up to 7" (178mm). Larger sizes include two 1/4 NPT female inlets on each half in order to maintain proper air volume and performance. Aluminum Super Air Wipes up to 4" (102mm) include a brass tee that supplies one half directly and a stainless steel wire braided coupling hose rated at 400°F (204°C) to supply the other half. Stainless Steel Super Air Wipes up to 4" (102mm) include a stainless steel tee and a stainless steel wire braided coupling hose rated at 800°F (427°C). Larger sizes should be piped directly.

Tapped holes on the back are provided for permanent mounting if the Super Air Wipe is not held in place with rigid pipe. Coupling brackets that hold each half of the Super Air Wipe together are provided which can be installed or removed quickly if required.

Air Wipe Dimensions

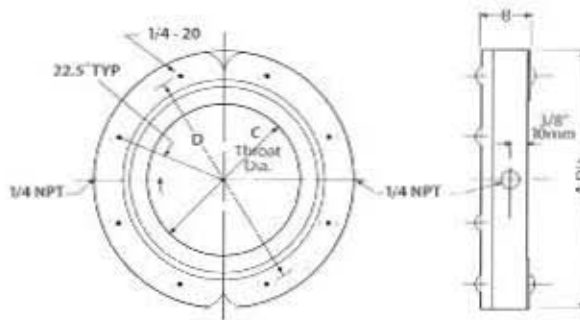

Super	Std		A	B	C	D
2400	2430	in	3.25	1.13	0.5	2.5
		mm	83	29	13	64
2401, 2401SS	2431	in	3.75	1.13	1.0	2.95
		mm	95	29	25	75
2402, 2402SS	2432	in	4.75	1.13	2.0	3.95
		mm	121	29	51	100
2403, 2403SS	2433	in	5.75	1.13	3.0	4.95
		mm	146	29	78	126
2404, 2404SS	2434	in	6.75	1.13	4.0	5.95
		mm	172	29	102	151
2405	2435	in	7.75	1.13	5.0	6.95
		mm	197	29	127	176
2406	2436	in	8.75	1.13	6.0	7.95
		mm	222	29	152	202
2407	2437	in	9.75	1.13	7.0	8.95
		mm	248	29	178	227
2409	2439	in	11.75	1.13	9.0	10.95
		mm	299	29	229	278
2411	2441	in	13.75	1.13	11.0	12.95
		mm	349	29	279	329

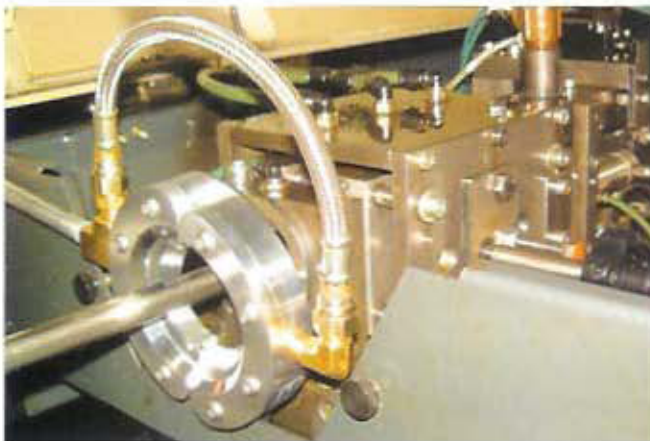

The Super Air Wipe eliminates the possibility of smoke during machining by wiping hydraulic oil from the bar stock as it enters the chuck.

Air Wipe Performance

80 PSIG (5.5 BAR)	Air Consumption		Sound Level @3' (91cm)
MODEL	SCFM	SLPM	dBA
2400, 2430	13.9	394	75
2401, 2401SS, 2431	19.1	541	76
2402, 2402SS, 2432	29.5	835	77
2403, 2403SS, 2433	39.8	1127	79
2404, 2404SS, 2434	50.2	1422	81
2405, 2435	60.6	1716	82
2406, 2436	71.0	2010	84
2407, 2437	81.3	2302	85
2409, 2439	102.1	2891	87
2411, 2441	122.8	3477	89

Super Air Wipe Specifications

The Super Air Wipe is available with throat diameters (I.D.) of 1/2", 1", 2", 3", 4", 5", 6", 7", 9", and 11" (13, 25, 51, 76, 102, 127, 152, 178, 229, and 279mm). **Special diameters are available. Contact the factory.**

Compressed Air Inlets: The Super Air Wipe has compressed air inlets on each half. Stainless steel wire braided hose is supplied with sizes up to 4" (102mm) that couples the air supply of one half to the other. Sizes 9" (229mm) and larger have two inlets on each half that must be supplied with compressed air to maintain uniform airflow.

Filtration: The use of clean air is essential. Kits include an automatic drain filter with a 5 micron filter element that is sized properly for flow.

Materials of Construction: The Super Air Wipe is constructed of aluminum or stainless steel. All models use stainless steel shims and screws. Stainless steel wire braided hose is included with sizes up to 4" (102mm).

Temperature: Aluminum Super Air Wipes are rated for temperatures up to 400°F (204°C). Stainless steel models are rated for temperatures to 800°F (427°C).

Mounting: The Super Air Wipe can be supported by the compressed air supply pipe. Tapped holes (1/4-20) on the bottom of the Super Air Wipe can also be used for mounting.

Regulation: A pressure regulator on the compressed air supply provides infinite control of flow, force and air consumption. Kits include a pressure regulator that is sized properly for flow.

Shim Sets: The Super Air Wipe has a .002" (.05mm) gap setting. The compressed air exhausts through a gap which is set with a stainless steel shim positioned between the cap and body of the Super Air Wipe. Force and flow through the Super Air Wipe may be easily increased by adding shims to open the gap. Kits include a shim set. Shim sets include (2) .002" (.05mm) thick stainless steel shims.

Super Air Wipe

Changing Performance By Adding Shims

The compressed air exhausts through a gap which is set with a shim positioned between the cap and the body of the Super Air Wipe. The Super Air Wipe is shipped with a .002" (.05mm) thick stainless steel shim installed which works best for most applications. Force and flow may be easily increased by adding shims to open the gap. Increasing the gap opening offers higher velocity and harder hitting force. Air consumption and noise will be slightly higher. Super Air Wipe shim sets include two .002" (.05mm) stainless steel shims that can be stacked. Shim sets are included with all kits or can be purchased separately.



The Super Air Wipe Kit includes a filter separator, pressure regulator and a stainless steel shim set.

Aluminum Super Air Wipe Only		
Model #	2400	
I.D.	1/2" (13 mm)	
2401	2402	2403
1" (25 mm)	2" (51 mm)	3" (76 mm)
2404	2405	2406
4" (102 mm)	5" (127 mm)	6" (152 mm)
2407	2409	2411
7" (178 mm)	9" (229 mm)	11" (279 mm)

Aluminum Super Air Wipe Kit		
Kit includes Super Air Wipe, filter separator, pressure regulator, shim set and coupling kit.		
Model #	2450	
I.D.	1/2" (13 mm)	
2451	2452	2453
1" (25 mm)	2" (51 mm)	3" (76 mm)
2454	2455	2456
4" (102 mm)	5" (127 mm)	6" (152 mm)
2457	2459	2461
7" (178 mm)	9" (229 mm)	11" (279 mm)

Stainless Steel Super Air Wipe		
Model #	2401SS	
I.D.	1" (25 mm)	
2402SS	2403SS	2404SS
2" (51 mm)	3" (76 mm)	4" (102 mm)

Stainless Steel Super Air Wipe Kit		
Kit includes Stainless Steel Super Air Wipe, filter separator, pressure regulator, shim set and coupling kit.		
Model #	2451SS	
I.D.	1" (25 mm)	
2452SS	2453SS	2454SS
2" (51 mm)	3" (76 mm)	4" (102 mm)

Super Air Wipe Shim Set		
Shim sets include (2) .002" (.05mm) thick stainless steel shims.		
Model #	2350SS	
I.D.	1/2" (13 mm)	
2351SS	2352SS	2353SS
1" (25 mm)	2" (51 mm)	3" (76 mm)
2354SS	2355SS	2356SS
4" (102 mm)	5" (127 mm)	6" (152 mm)
2357SS	2359SS	2361SS
7" (178 mm)	9" (229 mm)	11" (279 mm)

Accessories	
Model #	Description
9001	Auto Drain Filter Separator, 3/8 NPT, 65 SCFM (1841 SLPM)
9032	Auto Drain Filter Separator, 1/2 NPT, 90 SCFM (2548 SLPM)
9002	Auto Drain Filter Separator, 3/4 NPT, 220 SCFM (6230 SLPM)
9005	Oil Removal Filter, 3/8 NPT, 15-37 SCFM (425-1048 SLPM)
9006	Oil Removal Filter, 3/4 NPT, 50-150 SCFM (1415-4248 SLPM)
9008	Pressure Regulator, 1/4 NPT, 50 SCFM (1416 SLPM)
9033	Pressure Regulator, 1/2 NPT, 100 SCFM (2832 SLPM)
9009	Pressure Regulator, 3/4 NPT, 220 SCFM (6230 SLPM)
9020	Solenoid Valve, 120V, 50/60Hz, 1/4 NPT, 40 SCFM (1133 SLPM)
9034	Solenoid Valve, 120V, 50/60Hz, 1/2 NPT, 100 SCFM (2832 SLPM)
9036	Solenoid Valve, 120V, 50/60Hz, 3/4 NPT, 200 SCFM (5664 SLPM)

Special diameter Super Air Wipes are available.



A Model 2404 4" (102mm) Super Air Wipe cleans a steel rod after processing.